

PROJECT:
 ADDITIONAL ALTERATION PLAN OF 2NO. EXISTING
 G+V STORED & INO. PROPOSED G+V STORED
 BUILDING AT HOLDING NO.462, JESSORE ROAD,
 KOKATA - 700028. IN C.S. DAG NO. 2288 & 2300,
 MOUZA - DUMDUM CANT., J.L. NO.-13,
 R.S.NO.-177, TOLUZI NO.-3194,
 WARD NO.-21, P.S. - DUMDUM UNDER DUMDUM
 MUNICIPALITY.

- NOTES:**
1. ALL DIMENSIONS ARE IN mm. U.N.O
 2. GRADE OF CONCRETE SHALL BE M20
 3. GRADE OF REINFORCEMENT SHALL BE F500
 4. CLEAN COVER TO REINFORCEMENT SHALL BE
 a) FOR COLUMN - 40mm.
 b) FOR SLAB - 20mm
 5. MIN. OF F.C.C. SHALL BE 150
 6. LAP/JUNCTION LENGTH SHALL BE 50D WHERE D IS THE DIAMETER OF FLANGE BAR

CERTIFICATE OF OWNER:
 CERTIFIED THAT THE SIGNATURE OF THE MEMBER OF THE BOARD OF DIRECTORS OR ALTERNATE TO THE PLAN, CERTIFIED THAT THE WORK HAS BEEN DONE THROUGH THE BUILDING RULES FOR DUMDUM MUNICIPALITY AND IN ACCORDANCE WITH THE BUILDING RULES FOR DUMDUM MUNICIPALITY. I HAVE INDENTIFY DUMDUM MUNICIPALITY REGARDING TITLE OF LAND AND CONSTRUCTION OF THE BUILDING HAVE AS LAND OWNER CERTIFY THAT DISPUTE ARISES IN FUTURE REGARDING THE TITLE OF THE LAND.

TUSHAR JHONHUNWALA
 As Chairman of the Board of Directors
 21 Ma. Tapaniya (Panna) Ltd.
 8/16, Resident P.O. Panna, M.P.
 51 Ma. Nigrahada, Panna P.O. Ltd.
 7/16, India Christian Exports Pvt. Ltd.

SIGNATURE OF OWNER
Tushar Jhonhunjwala

CERTIFICATE OF ENGINEER:
 CERTIFIED THAT THE BUILDING'S DESIGN & SUPERSTRUCTURE OF THE BUILDING HAVE BEEN CONSIDERED & SUPERSTRUCTURE OF THE BUILDING IN RESPECT INVOLVING THE CONSIDERATION OF BEARING CAPACITY & IN ACCORDANCE WITH THE BUILDING RULES OF DUMDUM MUNICIPALITY. I HAVE INDENTIFY DUMDUM MUNICIPALITY FROM ANY STRUCTURAL DEFECT & FAILURE OF THE PROPOSED BUILDING AFTER OR DURING CONSTRUCTION.

KAMAL KUMAR PARNAL
 C.A. 66-19873

SIGNATURE OF LBS/ARCHITECT
Kamal Kumar Parnal

V. Senthil
 ROUSHIK SENAPATI
 B.E. E. - 1776 (K. M. C.I)

SIGNATURE OF STRUCTURAL ENGINEER
V. Senthil
 ARCHITECT: KAMAL KUMAR PARNAL
 MAHESHWARI & ASSOCIATES
 3/A, BANGS ROAD, 2ND FLOOR, KOLKATA - 700027.
 TEL: 8222854, WWW.ARCHITECTKAMALPARNAL.COM

ARCHITECT: KAMAL KUMAR PARNAL
MAHESHWARI & ASSOCIATES
 3/A, BANGS ROAD, 2ND FLOOR, KOLKATA - 700027.
 TEL: 8222854, WWW.ARCHITECTKAMALPARNAL.COM

SCALE - 1:100, 25:10
SCALE - 1:100, 25:10
SCALE - 1:100, 25:10

PART - BLOCK-C
SCALE - 1:100, 25:10
SCALE - 1:100, 25:10
SCALE - 1:100, 25:10

date-03-06-14
5172 MAHAATI NAGAR, BRATI,
KOLKATA-700051

sheet - 2 of 2

SCHEDULE OF SLABS (BACK SIDE BLOCK)

SLAB NO.	THICKNESS (mm)	TOP OVER SUPPORT	SHORTER BARS	LONGER BARS	TOP OVER SUPPORT	BOTTOM AT SPAN
S1	125	8TOR @ 150C	8TOR @ 150C	8TOR @ 150C	8TOR @ 150C	8TOR @ 150C
S2	100	8TOR @ 150C	8TOR @ 150C	8TOR @ 150C	8TOR @ 150C	8TOR @ 200C
S3	125	10TOR @ 150C	10TOR @ 150C	10TOR @ 150C	10TOR @ 150C	8TOR @ 200C

PROVIDE DISTRIBUTION TOR @ 300C/C WHERE NECESSARY

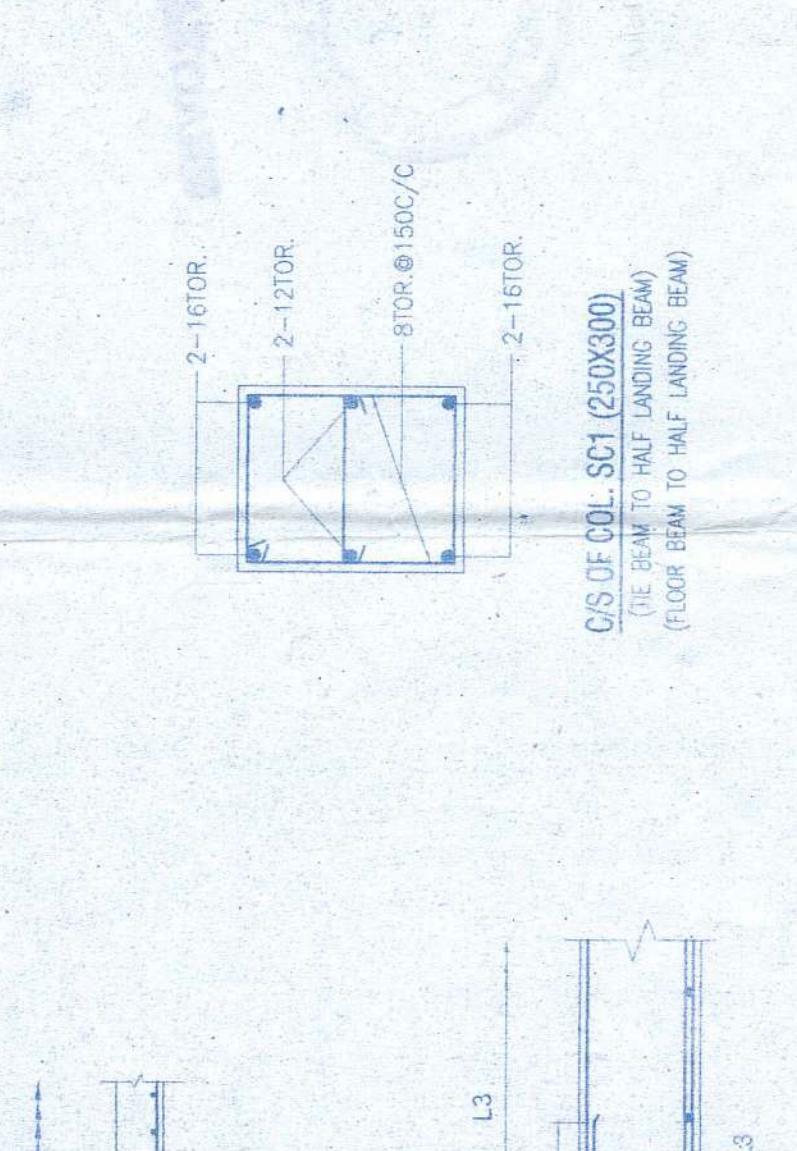
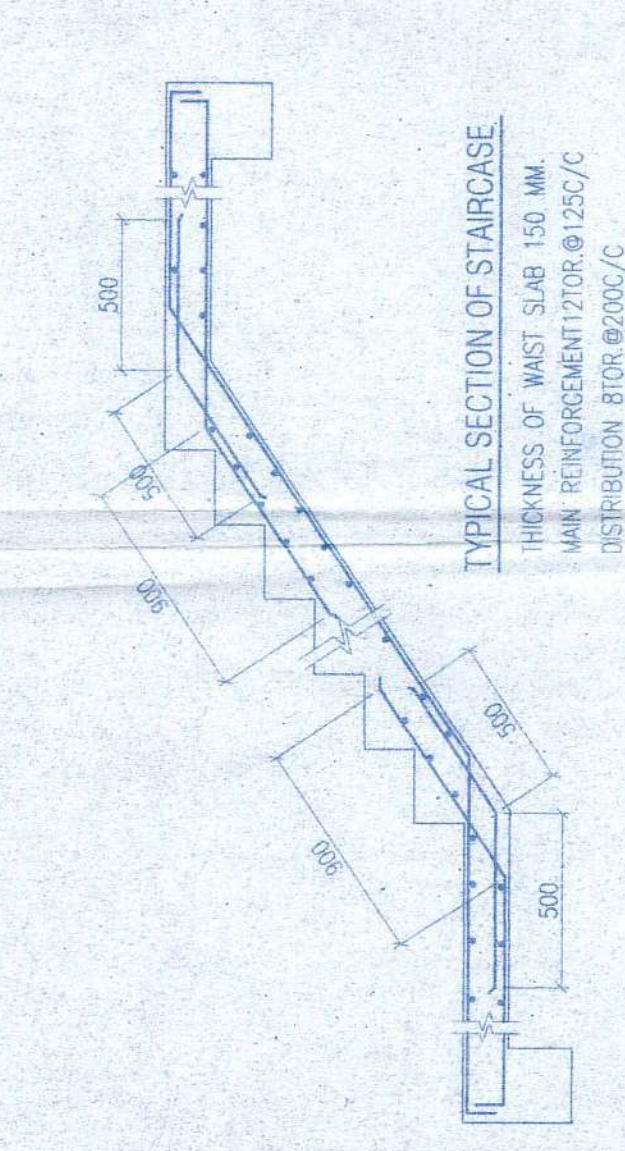

SCHEDULE OF BEAMS (FRONT BLOCK)

BEAM ID	AT SUPPORT		AT SPAN		STAIRS	SPAN
	TOP	BOTTOM	TOP	BOTTOM		
B1	2.0TOR @ 150C	2.0TOR @ 150C	2.0TOR @ 150C	2.0TOR @ 150C	2.0TOR @ 150C	2.0TOR @ 150C
B2	2.0TOR @ 150C	2.0TOR @ 150C	2.0TOR @ 150C	2.0TOR @ 150C	2.0TOR @ 150C	2.0TOR @ 150C
B3	2.0TOR @ 150C	2.0TOR @ 150C	2.0TOR @ 150C	2.0TOR @ 150C	2.0TOR @ 150C	2.0TOR @ 150C
B4	2.0TOR @ 150C	2.0TOR @ 150C	2.0TOR @ 150C	2.0TOR @ 150C	2.0TOR @ 150C	2.0TOR @ 150C
B5	2.0TOR @ 150C	2.0TOR @ 150C	2.0TOR @ 150C	2.0TOR @ 150C	2.0TOR @ 150C	2.0TOR @ 150C
B6	2.0TOR @ 150C	2.0TOR @ 150C	2.0TOR @ 150C	2.0TOR @ 150C	2.0TOR @ 150C	2.0TOR @ 150C
B7	2.0TOR @ 150C	2.0TOR @ 150C	2.0TOR @ 150C	2.0TOR @ 150C	2.0TOR @ 150C	2.0TOR @ 150C
B8	2.0TOR @ 150C	2.0TOR @ 150C	2.0TOR @ 150C	2.0TOR @ 150C	2.0TOR @ 150C	2.0TOR @ 150C
B9	2.0TOR @ 150C	2.0TOR @ 150C	2.0TOR @ 150C	2.0TOR @ 150C	2.0TOR @ 150C	2.0TOR @ 150C
B10	2.0TOR @ 150C	2.0TOR @ 150C	2.0TOR @ 150C	2.0TOR @ 150C	2.0TOR @ 150C	2.0TOR @ 150C

